

FEATURE

1. Metal Bushing
2. Sealed construction available
3. DPDT / 2.54 mm pitch

SPECIFICATIONS

CONTACT RATING: max 0.4 VA max @ 48 V AC or DC
 Min . 1 μ A /20 mV AC or DC
 ELECTRICAL LIFE:50,000 make-and-break cycles at full load
 CONTACT RESISTANCE: 50 m Ω max. initial @2-4 VDC,100 mA
 INSULATION RESISTANCE: 500 M Ω min.
 DIELECTRIC STRENGTH: 500 V RMS @ sea level.
 OPERATING TEMPERATURE: -30°C to +85°C

MATERIALS

Actuator - Copper alloy , chrome plated,internal o-ring seal are available
 Bushing and Housing - Stainless Steel
 CASE - glass filled nylon 4/6,flame retardant heat stabilized (UL94V-0)
 CONTACT -- phosphor bronze gold-plated over nickel plated
 TERMINAL - phosphor bronze tin plated over nickel plated
 TERMINAL SEAL - Epoxy

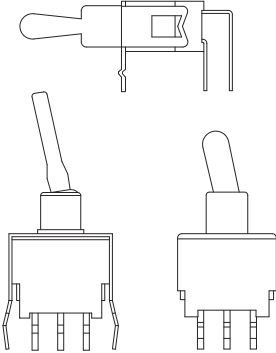

How do you modify the switches you need!!

E T - 4 - T 2 C K - A 5 S - T 4 - 3 -

Switches Function			Actuator		Contact Material		Toggle cap		RoHS code	
washable	Non-washable		T2	6.10	K	(std) gold / tin	T4	6.60	H = RoHS Compliant	
ET-4	ETN-4	SP on-none-on	U	flat 10.00	R	gold plated				
ET-4A	ETN-4A	SP on-off-on								
ET-4I	ETN-4I	SP on-off-(on)								
ET-5	ETN-5	DP on-none-on								
ET-5A	ETN-5A	DP on-off-on								
ET-5I	ETN-5I	DP on-off-(on)								
			Termination		Vertical support Bracket		color			
			C	P.C	(none)		1	white		
			C1	P.C	A5S	Vertical bracket	2	black		
			H	horizon			3	red		
			V	vertical						

* Vertical right angle type is on pending. For further information, please inquire our office.



SPDT

Model No.	Switching position		
ET-4	ON	none	ON
ET-4A	ON	OFF	ON
ET-4I	ON	OFF	(ON)
Term. Comm.	2-3	open	2-1

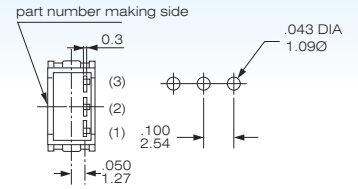
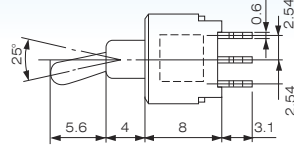
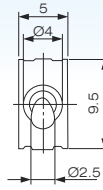

ET-4-T2CK

PC MOUNTING



DPDT

Model No.	Switching position		
ET-5	ON	none	ON
ET-5A	ON	OFF	ON
ET-5I	ON	OFF	(ON)
Term. Comm.	2-3,5-6	open	2-1,5-4

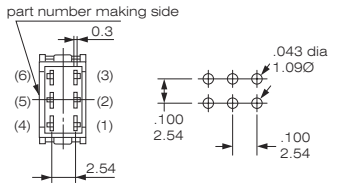
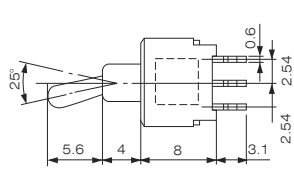
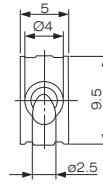

ET-5-T2CK

PC MOUNTING



SPDT

Model No.	Switching position		
ET-4	ON	none	ON
ET-4A	ON	OFF	ON
ET-4I	ON	OFF	(ON)
Term. Comm.	2-3	open	2-1

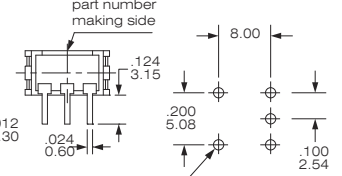
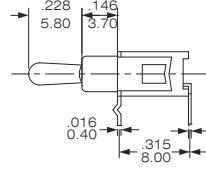
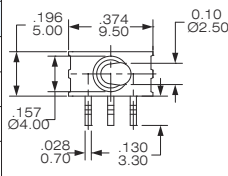

ET-4-T2HK

PC MOUNTING



DPDT

Model No.	Switching position		
ET-5	ON	none	ON
ET-5A	ON	OFF	ON
ET-5I	ON	OFF	(ON)
Term. Comm.	2-3,5-6	open	2-1,5-4

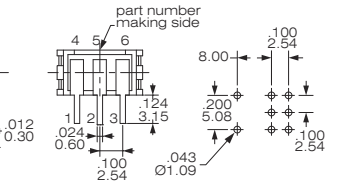
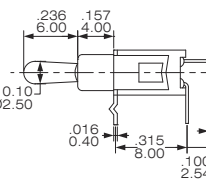
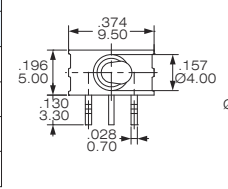

ET-5-T2HK

PC MOUNTING



SPDT

Model No.	Switching position		
ET-4	ON	none	ON
ET-4A	ON	OFF	ON
ET-4I	ON	OFF	(ON)
Term. Comm.	2-3	open	2-1

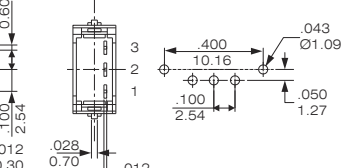
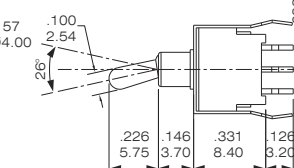
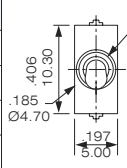

ET-4-T2CK-A5S

PC MOUNTING

Actuator Option

T2

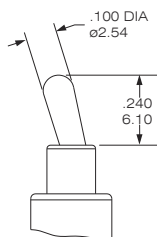

U

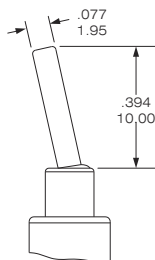

P.C Terminal Option

C

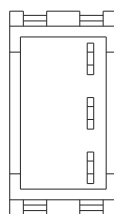

C1

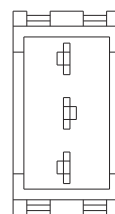

The bottom view of switch

Toggle cap option

T4

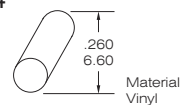

code	color
1	white
2	black
3	red